

DC HIGH VOLTAGE EV RELAY

EVD1000



EVD1000

PERFORMANCE

ITEM	PARAMETER
Contact Arrangement	SPST-NO
Auxiliary Contact	SPST-NO(Optional) MIN Load: 8Vdc 100mA ; Contact Resistance: ≤100mΩ
Voltage Rating	12-200Vdc 12-750Vdc 12-1000Vdc 12-1500Vdc
Current Rating	1-1000A
Current Endurance	1000A Cont. ; 1100A 10min. ; 1200A 120sec. ; 1400A 30sec.
Break Current, Max (only 1 time)	2500A 320Vdc
Contact Resistance (Initial)	≤1mΩ (at 1000A)
Operate Time (at 20°C)	40ms Max.
Bounce Time (at 20°C)	5ms Max.
Release Time (at 20°C)	20ms Max.
Mechanical Life (0.5s:0.5s)	2×10 <sup>5</sup> Cycles
Electrical Life	See graph
Current-carrying capacity curve	See graph
Insulation resistance	Initial: 100MΩ 1000Vdc
	After test: 50MΩ 1000Vdc
Impulse withstand voltage (initial)	Main contact 1mA/1min.(sea level) AC 3500Vrms
	Main contact & coil 1mA/1min.(sea level) AC 2500Vrms AC 3500Vrms
Mechanical performance	Shock 20G peak,11ms 1/2 Sine wave (coil energized)
	Vibration 20G peak,80-2000Hz,Sine wave (coil energized)
	Strength 50G acceleration, half sine wave impulse 6ms, 50 times per axis.
Operating & Storage Condition	Ambient Temperature -40~+85°C
	Humidity 5~95% RH.
Altitude	≤4000m
Weight	approx. 990g
Certification	UL、CE、CCC

COIL DATA

Coil Type	Nominal voltage (at 20°C)	Pick-up voltage (at 20°C)	Drop-out voltage (at 20°C)	Start-up current	Holding power (at 20°C)	Coil polarity
PWM	12-36Vdc	≤9Vdc	≥6Vdc	3.2A MAX	approx. 3.0W	non-polarized



DC HIGH VOLTAGE EV RELAY

EVD1000



PART CODE



DIMENSIONS

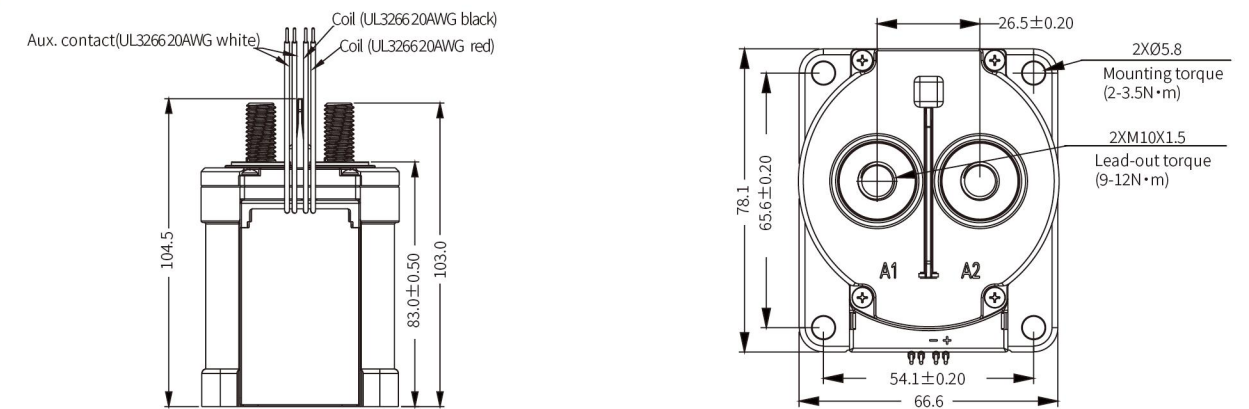

Note: 1.fastener:2xM10x8mm; 2.Mounting hardware M 5, torque 2-3.5N·m; 3.Main contact hardware M 10, torque 9-12N·m; 4.Main contact to copper area ≥500mm<sup>2</sup>;

GRAPHS

